

**APPLICATION FOR CONSIDERATION FOR A STORM WATER MANAGEMENT SITE PLAN
MANOR TOWNSHIP**

DATE OF RECEIPT _____

The undersigned hereby applies for approval under the Manor Township Storm Water Management Ordinance for the Storm Water Management Site Plan submitted herewith and described below:

1. Plan Name _____ Plan No. _____ Plan Date: _____

2. Project Location _____

3. Name of Applicant (if other than owner) _____

Address _____ Phone No. _____

4. Name of Property Owner(s) _____

Address _____ Phone No. _____

5. Land Use and Number of Lots and/or Units (indicate answer by number):

Single-Family (Detached) Commercial

Multi-Family (Attached-Sale) Industrial

Multi-Family (Attached-Rent) Institutional

6. Total Acreage _____

7. Application Classification: (Check One)

Minor Land Disturbance Major Land Disturbance

I am aware that I cannot commence development of the property and cannot commence excavation, earthmoving, grading, or construction until a plan has been recorded in the office of the Recorder of Deeds or until a Storm Water Management Site Plan has been approved by Manor Township. By signing this application, I certify that all facts in the application and all accompanying documentation are true and correct. This application is being made by me to induce official action on the part of Manor Township, and I understand that any false statements made herein are being made subject to the penalties of 18 Pa. C.S. Section 4904 relating to unsworn falsification to authorities. **I understand and I am aware of and agree to reimburse Manor Township for engineering review, inspection, recording and reasonable attorney fees incurred by Manor Township.**

Date

Signature of Landowner or Applicant

Manor Township Stormwater Specifications for Small Residential Project.

The factor to be used to size a typical infiltration trench for Manor Township is 0.50 (impervious area in square feet x 0.50 = trench volume in cubic feet) and is based upon the following assumptions:

- Universal Rational Method
- $C=0.95$
- $I=8.19$ "/hr for 100-yr
- $T_c=5$ minutes
- 40% stone voids
- No infiltration
- Factor of safety of 1.25
- A entered in square feet

See attached Typical infiltration system (Seepage Bed) Details

ADMINISTRATIVE REVIEW FEE; \$100.00 Payable to Manor Township

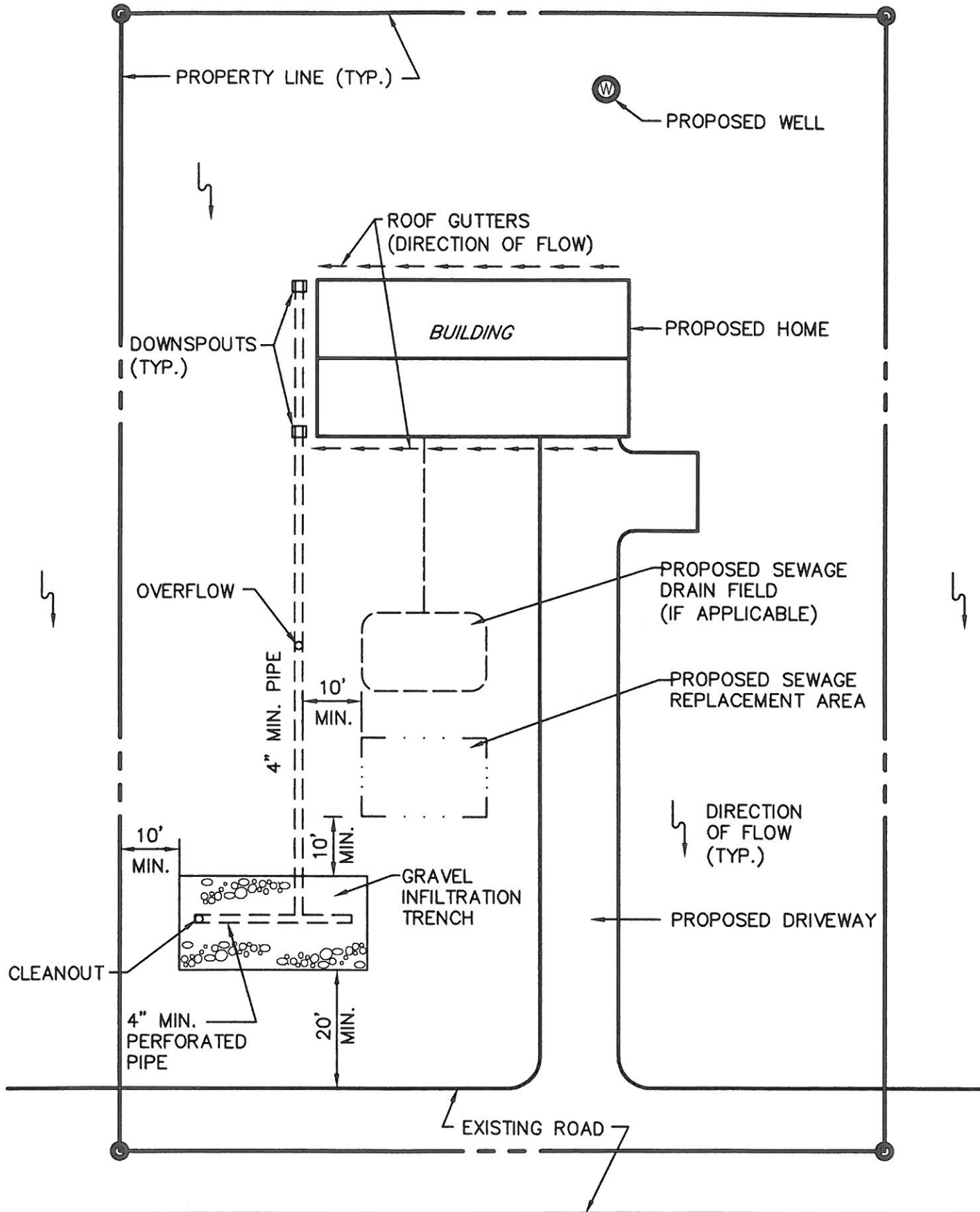
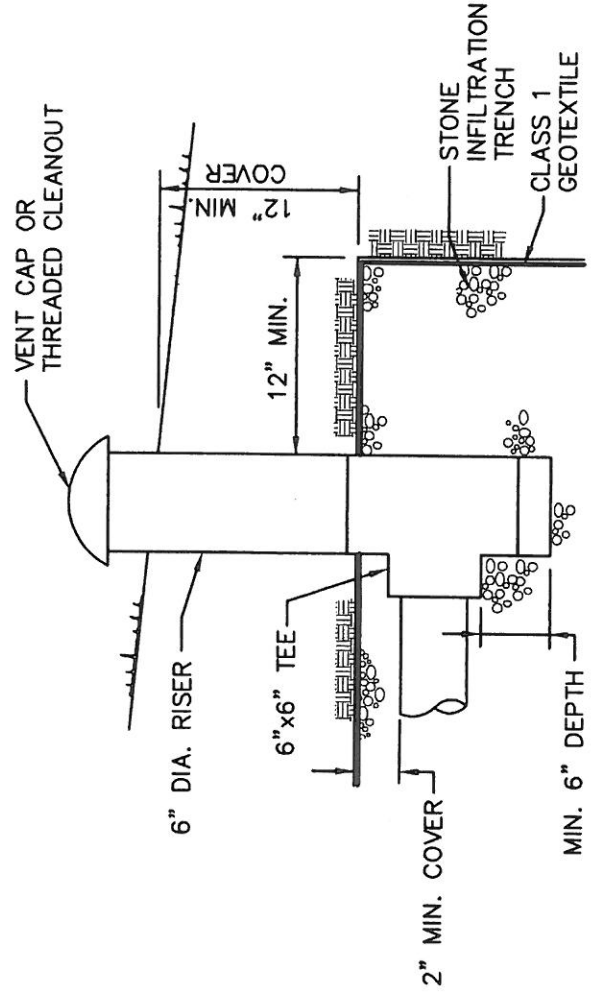
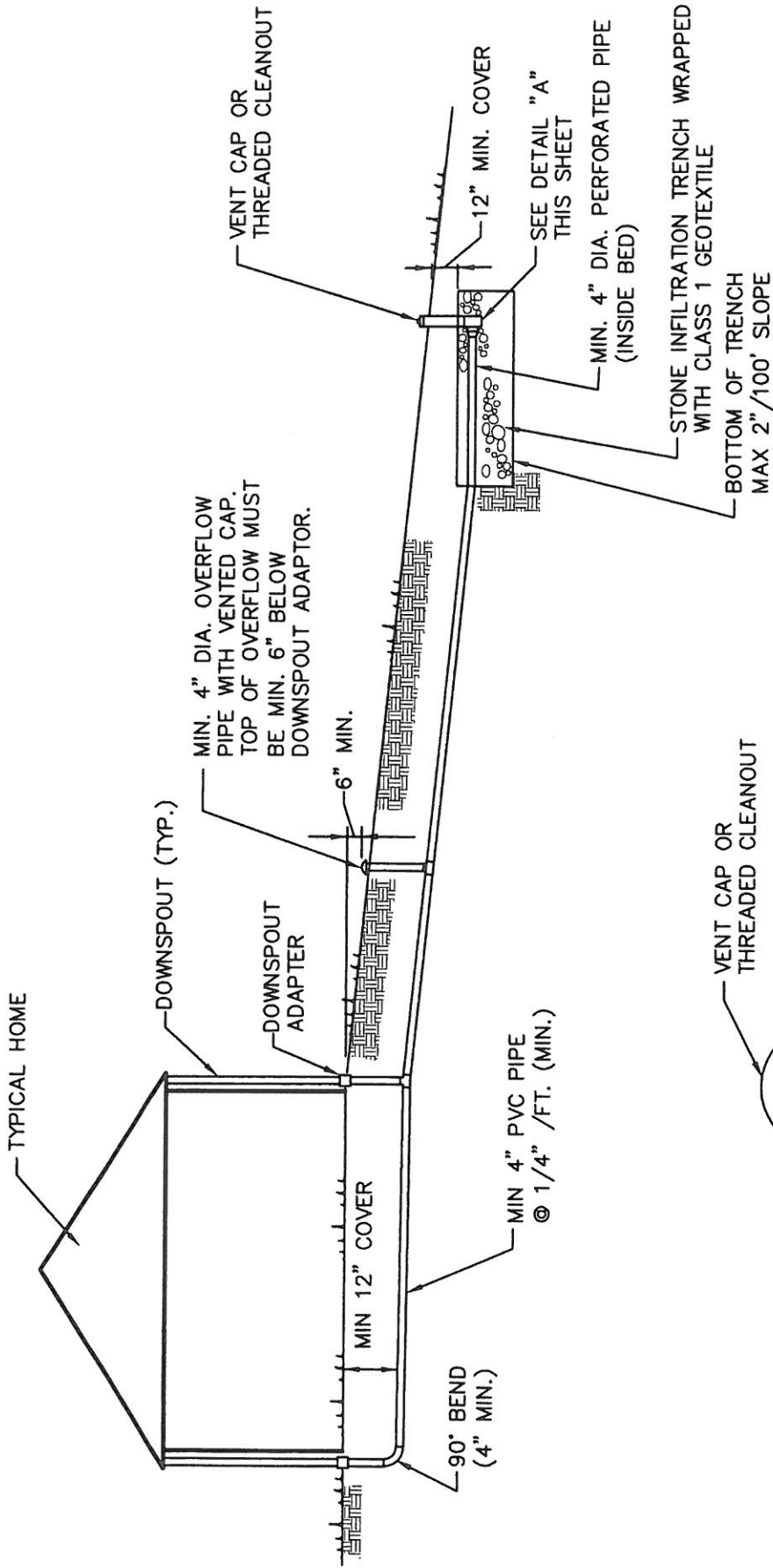

EXHIBIT A
 TYPICAL INFILTRATION TRENCH PLAN
 MANOR TOWNSHIP LANCASTER COUNTY



DETAIL "A"

NOT TO SCALE